

Inflatable chiller tub installation manual

Version:01



Thank you very much for purchasing our product, please keep and read this manual carefully before you install the inflatable chiller tub.

Packing List:



Item	Description	QTY	Item	Description	QTY
1	Heat pump	1 set	8	Quick connector	4 pcs
2	Air pump	1pc	9	connector	2pcs
3	Inflatable tub	1pc	10	Spanner	1pcs
4	Circulation pump	1pc	11	Water hose 3/4"	1pcs
5	Circulation pump power adapter	1pcs	12	0.3m water hose 3/4"	2pcs
6	filter	1pcs	13	0.15m water hose 3/4"	1pcs
7	Stainless steel hose clamp	4 pcs	14	Water tape	1 roll

1、 Installation steps

1.1: Unscrew the inflatable valve cap.



1.2: Connect the air pump hose to the air pump.

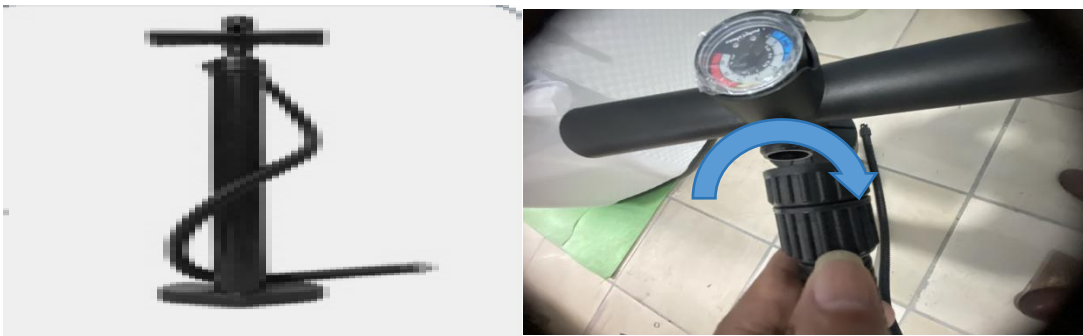

1.3: Connect the Air pump hose to the inflatable tub valve.



1.4: Pump the air to the inflatable tub till the pressure pointer point to the green area as show below the air pump pressure meter.

meter.



1.5: After pumping the air, screw the inflatable valve cap.



1.6: See inflatable valve cap notes on usage.



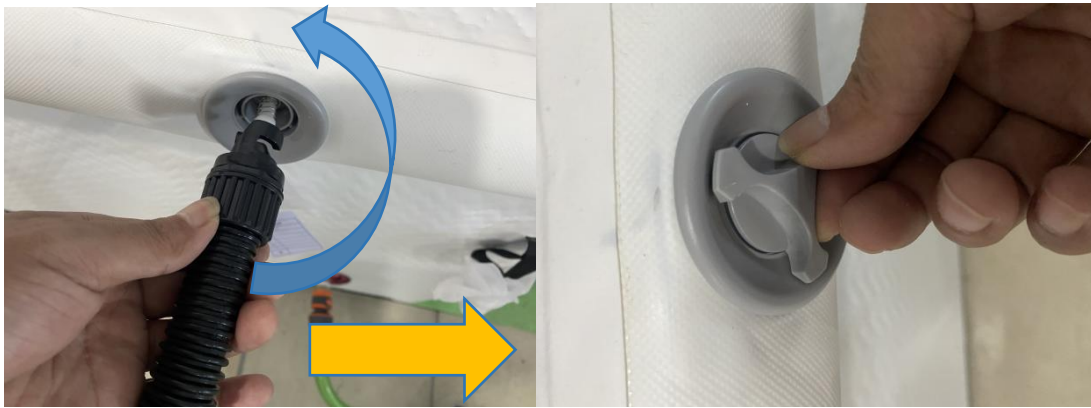

2、 Connect the tub water inlet and outlet

2.1: Unscrew the water inlet cap.



2.2: Prepare the quick connector female.



2.3: Connect the water inlet with the quick connector female.



2.4: Same way as water inlet to the water outlet.



3、 Connect the heat pump water inlet and outlet

3.1: Prepare the inlet and outlet adapter. Screw them to the heat pump water inlet and outlet.



4、 Connect the circulation pump and filter

4.1: Connect the filter assembly (note: on the left of the filter hose should be 30CM long, hose on the right should be 15CM)



4.2: Connect the circulation pump and filter assembly



Prepare the circulation pump and quick connectors



Screw the quick connector female to the circulation water inlet

and outlet.



4.3: Connect water inlet assembly to the inflatable tub water inlet.

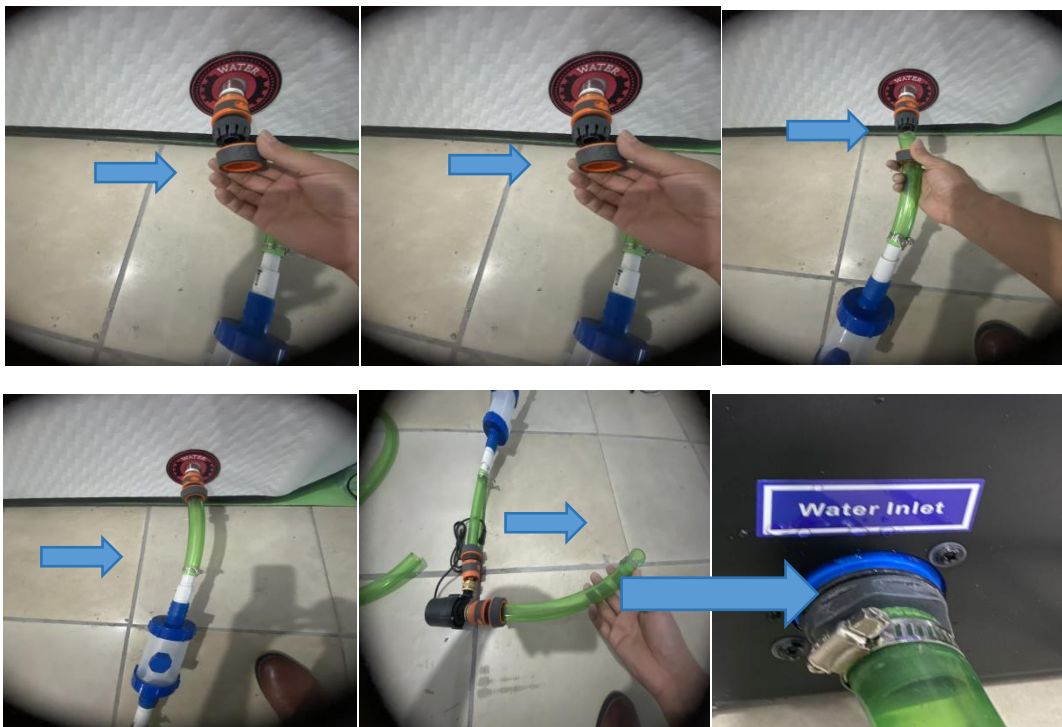

4.4: Connect the water outlet with the 1.5 meters hose, one end to the inflatable tub, one end to the heat pump water outlet.





4.5: Connect the circulation pump power adapter quick connection.



5. Fill the water

1: Fill the inflatable tub with clean tap water. The request water level is just over the water inlet. (See drawing below)



2. Please check if there is any leaking point at any connections. Make sure all the connection has no water leakage.

3. Keep the inflatable tub cover close and power on the heat pump and the circulation pump. Following to the heat pump users manual for the operating of the heat pump.



Important Note: Make sure the inflatable tub requested water level is reached before you run the heat pump.